

Lansing and Vicinity

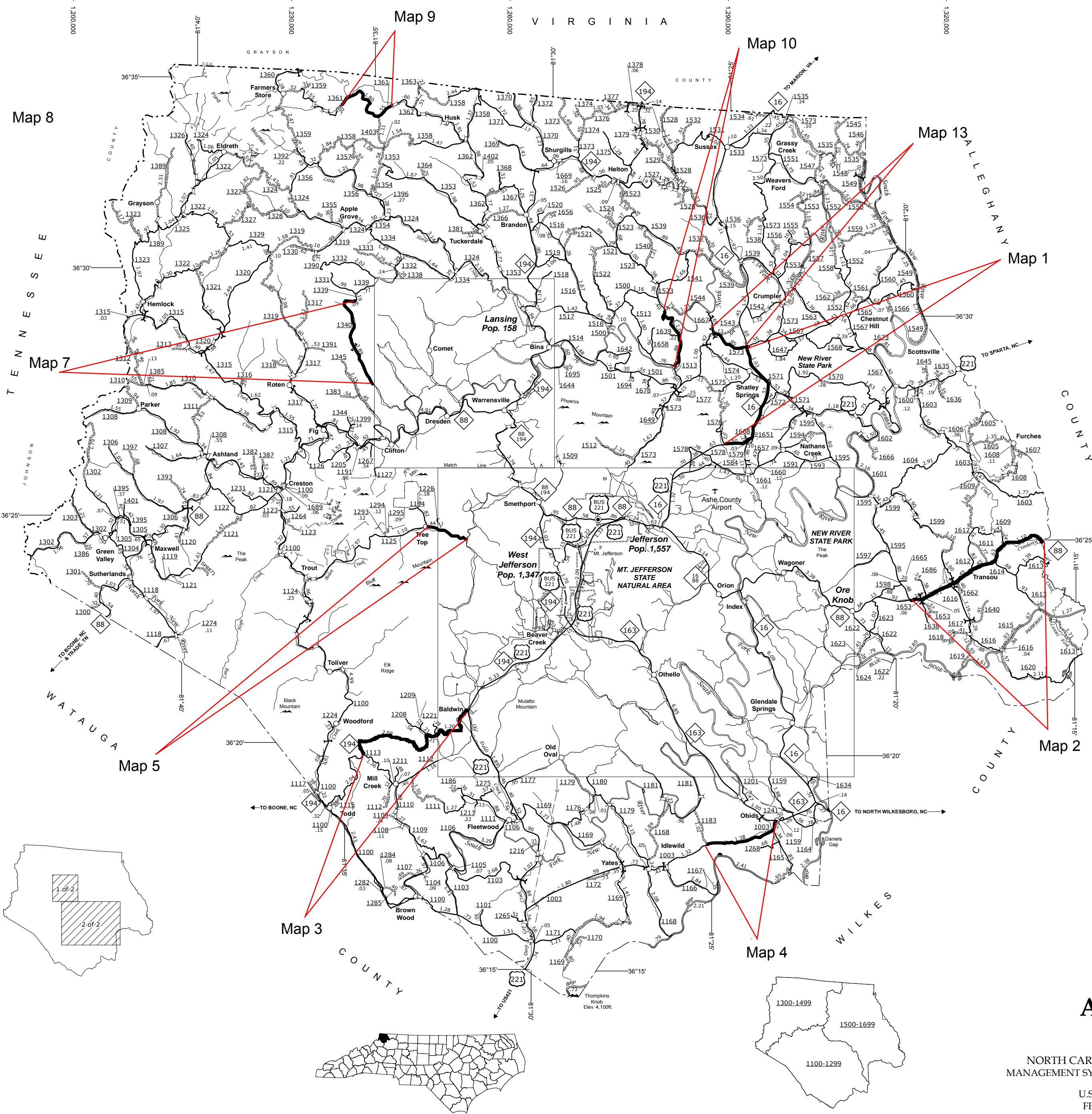

Map 8

Map 7

Map 5

Map 3

Map 9

Map 10

Map 13

Map 1

Map 2

The MS&J's goal is to provide the most accurate and current information possible. Map data is compiled from numerous sources and is subject to change. As a result, some information may be out of date. The MS&J's goal is to provide the most accurate and current information possible. Map data is compiled from numerous sources and is subject to change. As a result, some information may be out of date. The MS&J's goal is to provide the most accurate and current information possible. Map data is compiled from numerous sources and is subject to change. As a result, some information may be out of date.

COPIES OF THIS MAP ARE AVAILABLE FROM THE NORTH CAROLINA DEPARTMENT OF TRANSPORTATION, MANAGEMENT SYSTEMS AND ASSESSMENTS UNIT - MAPPING SECTION, 4809 BERTHLETT ROAD, RALEIGH, NC 27609

- LEGEND**
- UNPAVED SURFACE ROAD
  - HARD SURFACE ROAD
  - 4 LANE UNDIVIDED HIGHWAY
  - DIVIDED HIGHWAY W/FRONTAGE ROADS
  - FULL CONTROL ACCESS (SNETS)
  - NON-SYSTEM ROADS
  - PREDICTED LOCATION
  - NATIONAL PARK ROAD
  - BLUE RIDGE PARKWAY
  - INTERSECTION DISTANCE
  - TRAFFIC CIRCLE
  - DETAILED HIGHWAY INTERCHANGE
  - ROAD THROUGH MOUNTAIN PASS
  - HIGHWAY BRIDGE
  - RAILROAD BRIDGE
  - DRAW SPAN ON BRIDGE
  - PEDESTRIAN BRIDGE
  - PEDESTRIAN WALKWAY
  - PEDESTRIAN UNDERPASS
  - VEHICULAR UNDERPASS
  - FORD
  - TUNNEL
  - CULVERT
  - PIPE
  - INTERSTATE HIGHWAY
  - U.S. NUMBERED HIGHWAY
  - N.C. NUMBERED HIGHWAY
  - U.S. NUMBERED BICYCLE ROUTE
  - N.C. NUMBERED BICYCLE ROUTE
  - INTERSTATE INTERCHANGE NUMBER
  - SECONDARY ROAD NUMBER
  - UTILITY LINES
  - RAILROAD
  - RAILROAD STATION
  - RAILROAD CROSSING
  - GRADE CROSSING
  - INSET AREA
  - URBAN EXTENSION LINE
  - NATIONAL FOREST BOUNDARY
  - RESERVATION OR PARK BOUNDARY
  - STATE FOREST BOUNDARY
  - STATE GAMBEL BOUNDARY
  - FEDERAL GAMBEL BOUNDARY
  - MILITARY RESERVATION BOUNDARY
  - STATE LINE
  - COUNTY LINE
  - CITY LIMIT
  - FERRY ROUTE
  - CANAL
  - NARROW CREEK OR STREAM
  - WIDE RIVER OR CREEK
  - RESERVOIR, POND OR LAKE W/ ISLAND
  - DAM OR DAM WITH LOCK
  - WATERFALL
  - SWAMP
  - COMMUNITY, TOWN OR CITY CENTER
  - COUNTY SEAT
  - STATE CAPITAL
  - SCHOOL
  - COLLEGE OR UNIVERSITY
  - HOSPITAL
  - COAST GUARD STATION
  - CHURCH
  - CHURCH WITH CEMETERY
  - CEMETERY
  - PATROL STATION
  - CORRECTION OR PENAL INSTITUTION
  - QUARRY
  - MINE OR PIT
  - HIGHWAY GARAGE OR MAINT. YARD
  - HIGHWAY DIV. OR DIST. OFFICE
  - POST OFFICE
  - MILITARY POST
  - WILDLIFE REFUGE
  - WEIGH STATION
  - FAIRGROUNDS
  - HISTORICAL SITE
  - POINTS OF INTEREST
  - STATE FOREST
  - LIGHTHOUSE
  - MOUNTAIN SUMMIT
  - OVERLOOK
  - GEODEIC MARKER
  - REST AREA
  - VISITOR CTR. REST AREA
  - WELCOME CTR. REST AREA
  - MAJOR AIRPORT
  - AIRPORT
  - MILITARY AIRPORT
  - HELIPORT

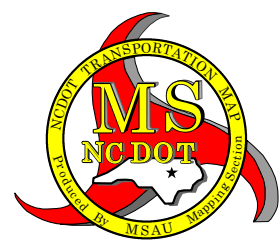
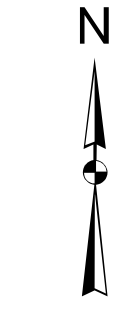

**ASHE COUNTY  
NORTH CAROLINA**

PREPARED BY THE  
NORTH CAROLINA DEPARTMENT OF TRANSPORTATION  
MANAGEMENT SYSTEMS AND ASSESSMENTS UNIT - MAPPING SECTION  
IN COOPERATION WITH THE  
U.S. DEPARTMENT OF TRANSPORTATION  
FEDERAL HIGHWAY ADMINISTRATION

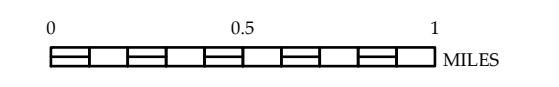
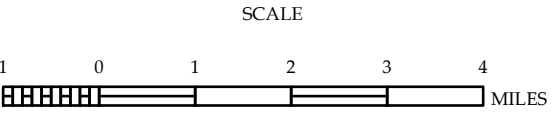

SCALE FOR ENLARGEMENTS  
10,000 FOOT GRID BASED ON NORTH CAROLINA PLANE COORDINATE SYSTEM  
LAMBERT CONFORMAL CONIC PROJECTION

The MSJAT's goal is to provide the most accurate and current information possible. Map data is compiled from numerous sources and is not guaranteed to be 100% accurate. As a result, the MSJAT does not assume any liability for errors or omissions. For additional information, visit <http://www.ncdot.gov/MSJAT/MSJAT.html> and click on Data Providers or contact us at (810) 935-8400.

COPIES OF THIS MAP ARE AVAILABLE FOR PURCHASE AT A PUBLIC NOMINAL COST. ADDRESS: N.C. DEPARTMENT OF TRANSPORTATION, MSJAT MAPPING SECTION, 4809 BERRY RD, RALEIGH, NC 27609

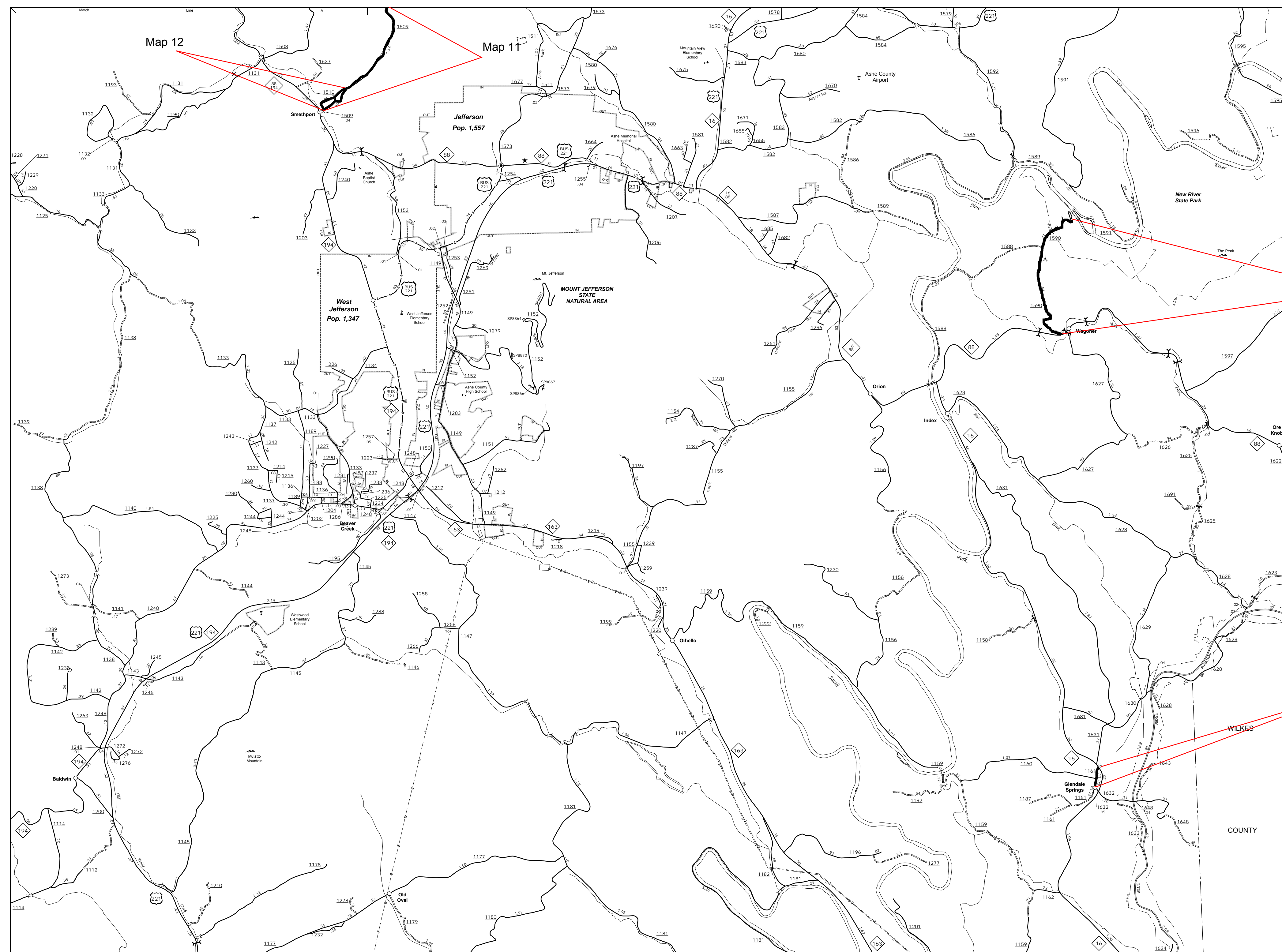

Jefferson and West Jefferson

ENLARGED MUNICIPAL AND SUBURBAN AREAS

**ASHE COUNTY  
NORTH CAROLINA**

PREPARED BY THE  
NORTH CAROLINA DEPARTMENT OF TRANSPORTATION  
MANAGEMENT SYSTEMS AND ASSESSMENTS UNIT - MAPPING SECTION  
IN COOPERATION WITH THE  
U.S. DEPARTMENT OF TRANSPORTATION  
FEDERAL HIGHWAY ADMINISTRATION

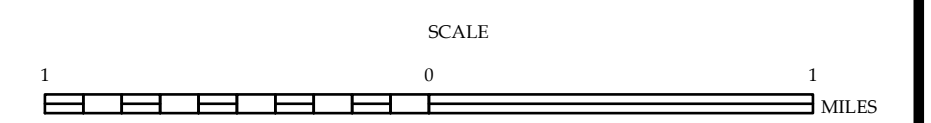

10,000 FOOT GRID BASED ON NORTH CAROLINA PLANE COORDINATE SYSTEM  
LAMBERT CONFORMAL CONIC PROJECTION











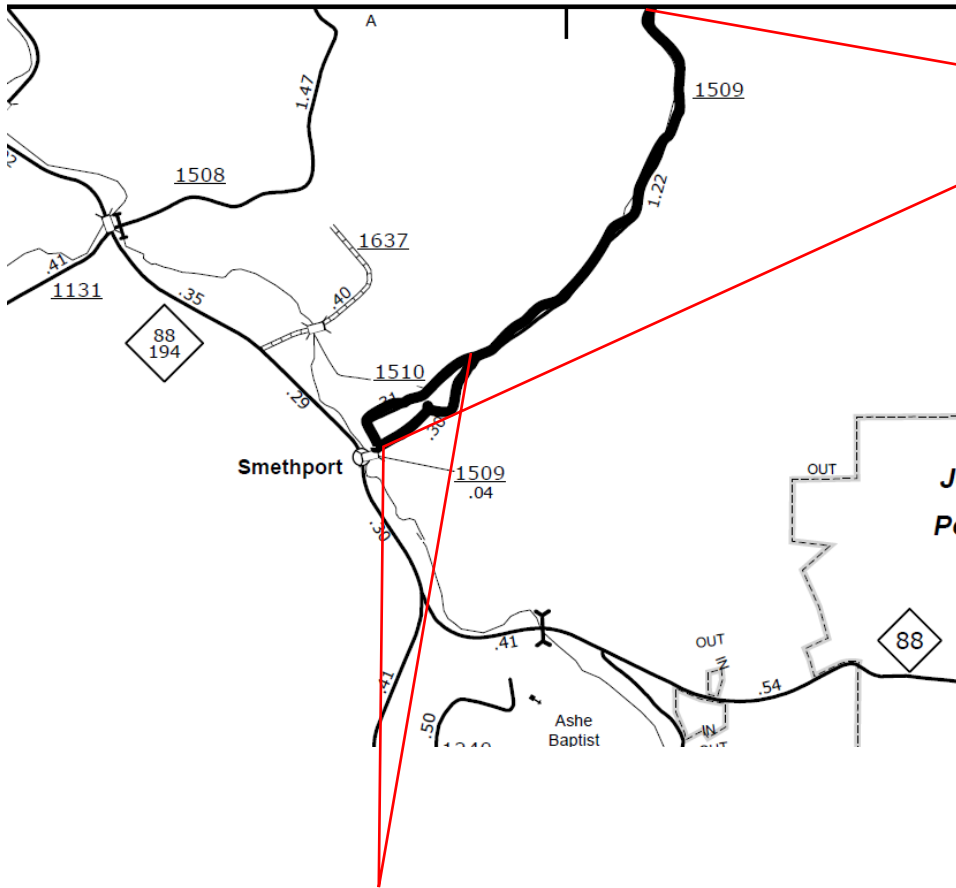

Map 11  
 SR 1509 (Claybank Road)  
 From SR 1510 (Smethport Drive)  
 to End of Maintenance

Map 12  
 SR 1510 (Smethport Drive)  
 From SR 1509 (Claybank Road)  
 to SR 1509 (Claybank Road)





# TYPICALS AND PAVEMENT SCHEDULES

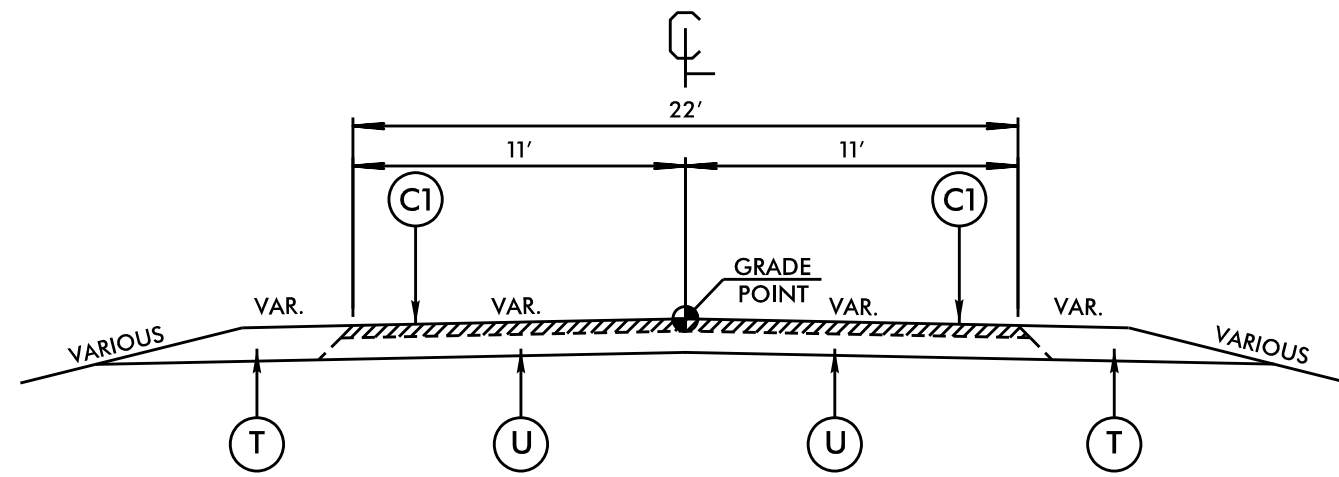

**TYPICAL SECTION NO. 1**

FOR MAP # 1 NC HWY 16

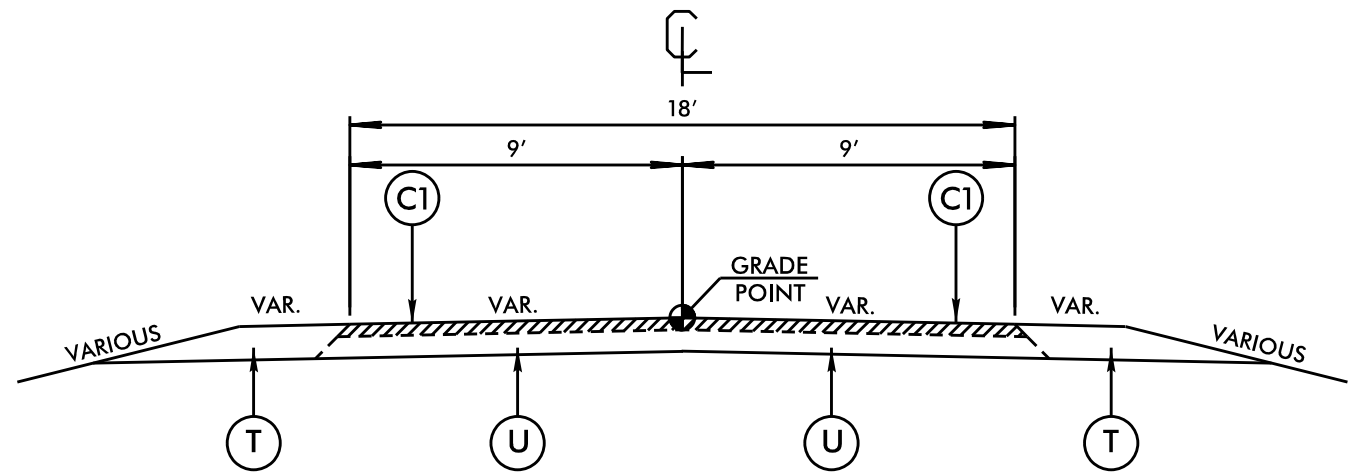

**TYPICAL SECTION NO. 3**

FOR MAP # 3 NC HWY 194

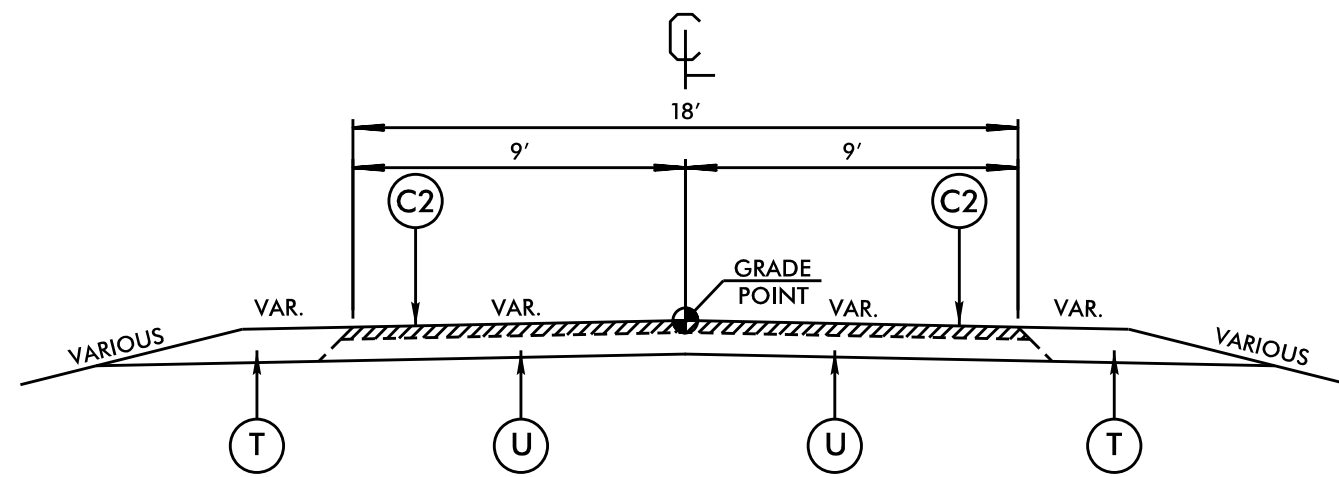

**TYPICAL SECTION NO. 2**

FOR MAP # 2 NC HWY 88

C1	PROP. APPROX. 1½" ASPHALT CONCRETE SURFACE COURSE, TYPE S9.5A, AT AN AVERAGE RATE OF 168 LBS. PER SQ. YD.
C2	PROP. APPROX. 1½" ASPHALT CONCRETE SURFACE LEVELING COURSE AND PROP. APPROX. 1½" ASPHALT CONCRETE SURFACE COURSE, TYPE S9.5B, AT AN AVERAGE RATE OF 168 LBS. PER SQ. YD.
U	EXISTING PAVEMENT
T	PROPOSED SHOULDER MATERIAL

# TYPICALS AND PAVEMENT SCHEDULES

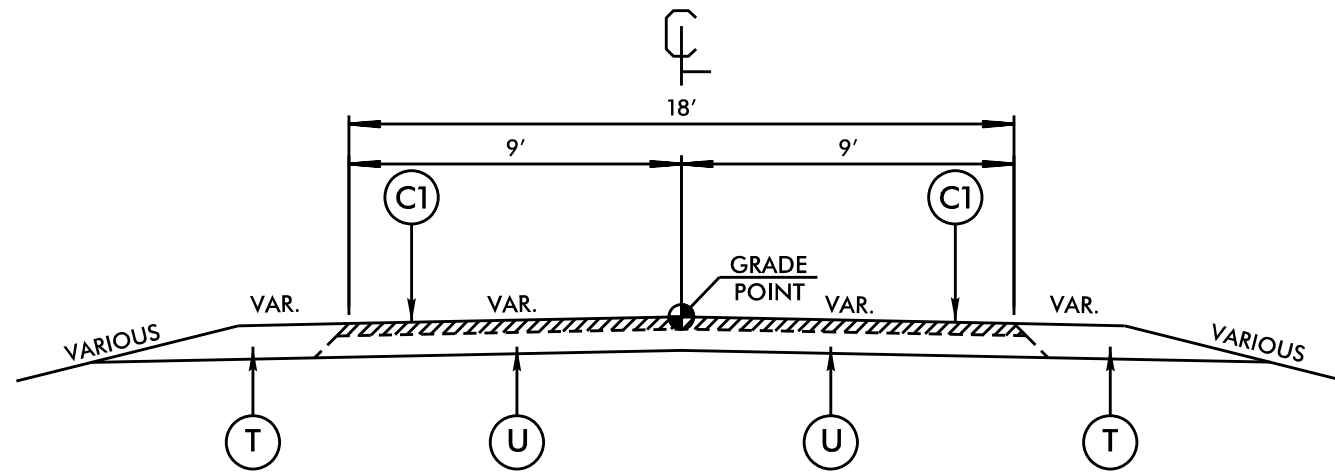

**TYPICAL SECTION NO. 1**

FOR MAP # 5,6,7,9,10,13 AND 14

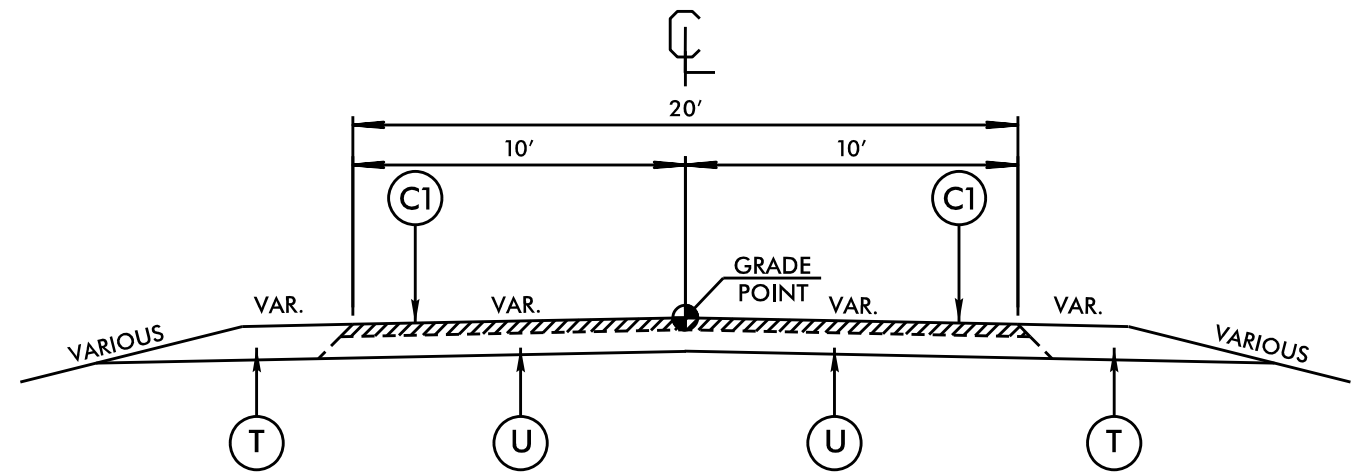

**TYPICAL SECTION NO. 3**

FOR MAP # 4 AND 8

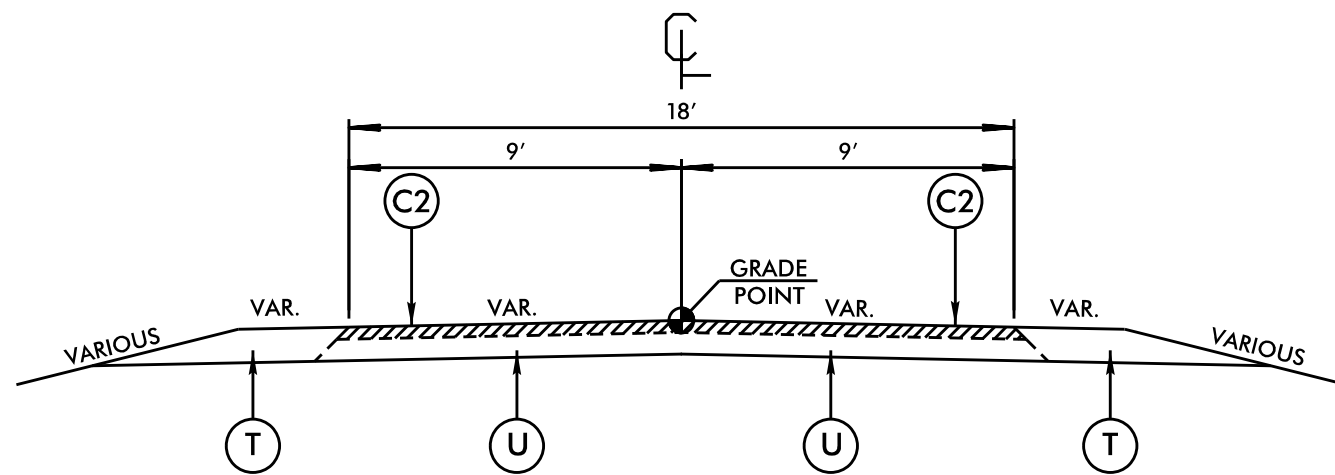

**TYPICAL SECTION NO. 2**

FOR MAP # 11 AND 12

C1	PROP. APPROX. 1½" ASPHALT CONCRETE SURFACE COURSE, TYPE S9.5A, AT AN AVERAGE RATE OF 168 LBS. PER SQ. YD.
C2	PROP. APPROX. 1½" ASPHALT CONCRETE SURFACE COURSE, TYPE S9.5B, AT AN AVERAGE RATE OF 168 LBS. PER SQ. YD.
U	EXISTING PAVEMENT
T	PROPOSED SHOULDER MATERIAL

PROJECT NO.	SHEET NO.	TOTAL NO.
2018CPT.11.03.10051		
2018CPT.11.03.20051		

## SUMMARY OF QUANTITIES

PROJECT NO	COUNTY	MAP NO	ROUTE	DESCRIPTION	TYP NO	LANES	LANE TYPE	LENGTH	WIDTH	BORROW	INCIDENTAL STONE BASE	SHOULDER RECONSTRUCTION	INCIDENTAL MILLING	SURFACE COURSE, S9.5B TONS	LEVELING COURSE, S9.5B TONS	SURFACE COURSE, SF9.5A TONS	ASPHALT BINDER FOR PLANT MIX TONS	SEED & MULCHING AC
								M	FT	CY	TONS	SM	SY					
2018CPT.11.03.10051	Ashe	1	NC 16	FROM SR 1576 (FLAT ROCK ROAD) TO SR 1573 (OLD HIGHWAY 16)	1	2	2WU	3.4	22	340	100	6.00	150			3,806	255	2.46
2018CPT.11.03.10051	Ashe	2	NC 88	FROM SR 1595 (LITTLE PEAK CREEK ROAD) TO ALLEGHANY COUNTY LINE	2	2	2WU	4.1	18	410	100	8.02	300	3,827	1,825		348	3.00
2018CPT.11.03.10051	Ashe	3	NC 194	FROM SR 1113 (LAURAL KNOB ROAD) TO US 221	1	2	2WU	4.48	18	448	75	8.96				4,030	270	3.24
<b>TOTAL FOR PROJ NO. 2018CPT.11.03.10051</b>								<b>11.98</b>		<b>1,198</b>	<b>275</b>	<b>22.98</b>	<b>450</b>	<b>3,827</b>	<b>1,825</b>	<b>7,836</b>	<b>873</b>	<b>8.70</b>
2018CPT.11.03.20051	Ashe	4	SR 1003 1003 (IDLEWILD ROAD)	FROM NC 163 TO SR 1183 (CANOE GAP ROAD)	1	2	2WU	2.07	20	207	50	8.57				2,041	137	1.50
2018CPT.11.03.20051	Ashe	5	SR 1125 (W. BUFFALO ROAD)	FROM SR 1194 (SADDLE GAP ROAD) TO SR 1133 (CENTRAL BUFFALO ROAD)	1	2	2WU	1.2	18	120	25	2.40				1,073	72	0.88
2018CPT.11.03.20051	Ashe	6	SR 1161 (J. W. LUKE ROAD)	FROM NC 16 TO SR 1632 (TRADING POST ROAD)	1	2	2WU	0.18	18	18	2	0.36				208	14	0.13
2018CPT.11.03.20051	Ashe	7	SR 1340 (W. MILL CREEK ROAD)	FROM SR 1339 (ROARING BRANCH ROAD) TO MILE POST 2.0	1	2	2WU	2.38	18	238	20	4.76				2,103	141	1.74
2018CPT.11.03.20051	Ashe	8	SR 1352 (E. STAGGS CREEK ROAD/LONGBRANCH ROAD)	FROM SR 1394 (GLENN MILLER ROAD) TO SR 1394 (E. LITTLE HORSE CREEK ROAD)	1	2	2WU	3.94	20	394	50	7.88				3,858	258	2.86
2018CPT.11.03.20051	Ashe	9	SR 1361 (RIP SHIN ROAD)	FROM 1.74 MILES SOUTH OF SR 1359 (WHENLIN ROAD) TO SR 1362 (BIG HORSE CREEK ROAD)	1	2	2WU	2.35	18	235	25	4.70	150			2,087	140	1.71
2018CPT.11.03.20051	Ashe	10	SR 1500	FROM SR 1513 TO SR 1544	1	2	2WU	1.92	18	192	50	7.37				1,709	115	1.40
2018CPT.11.03.20051	Ashe	11	SR 1509 (CLAYBANK ROAD)	FROM SR 1510 (SMETHPORT DRIVE) TO END OF STATE MAINTENANCE	3	2	2WU	1.52	18	152	25	3.04		1,358			81	0.30
2018CPT.11.03.20051	Ashe	12	SR 1510 (SMETHPORT DRIVE)	FROM SR 1509 (CLAYBANK ROAD) TO SR 1509 (CLAYBANK ROAD)	3	2	2WU	0.31	18	31	25	0.62		302			18	0.23
2018CPT.11.03.20051	Ashe	13	SR 1573 (OLD HIGHWAY 16)	FROM SR 1573 (AUBREY TURNER ROAD) TO NC 16	1	2	2WU	0.98	18	98	25	1.96	150			885	59	0.71
2018CPT.11.03.20051	Ashe	14	SR 1590 (WAGONER ACCESS ROAD)	FROM NC 88 TO WAGONER ACCESS GATE	1	2	2WU	1.08	18	108	25	2.16				957	64	0.79
<b>TOTAL FOR PROJ NO. 2018CPT.11.03.20051</b>								<b>17.93</b>		<b>1,793</b>	<b>322</b>	<b>43.82</b>	<b>300</b>	<b>1,660</b>		<b>14,921</b>	<b>1,099</b>	<b>12.25</b>
<b>GRAND TOTAL</b>								<b>29.91</b>		<b>2,991</b>	<b>597</b>	<b>66.80</b>	<b>750</b>	<b>5,487</b>	<b>1,825</b>	<b>22,757</b>	<b>1,972</b>	<b>20.95</b>



- NOTES:  
 1) DETAIL DOES NOT APPLY TO OGAFB AND ULTRA-THIN BONDED WEARING COURSE.  
 2) BACKFILL SHOULDER WITH APPROVED MATERIAL.  
 3) THE SHOULDER WEDGE DEVICE MAY BE DISENGAGED AT PAVED DRIVEWAYS AND SIDE STREETS.

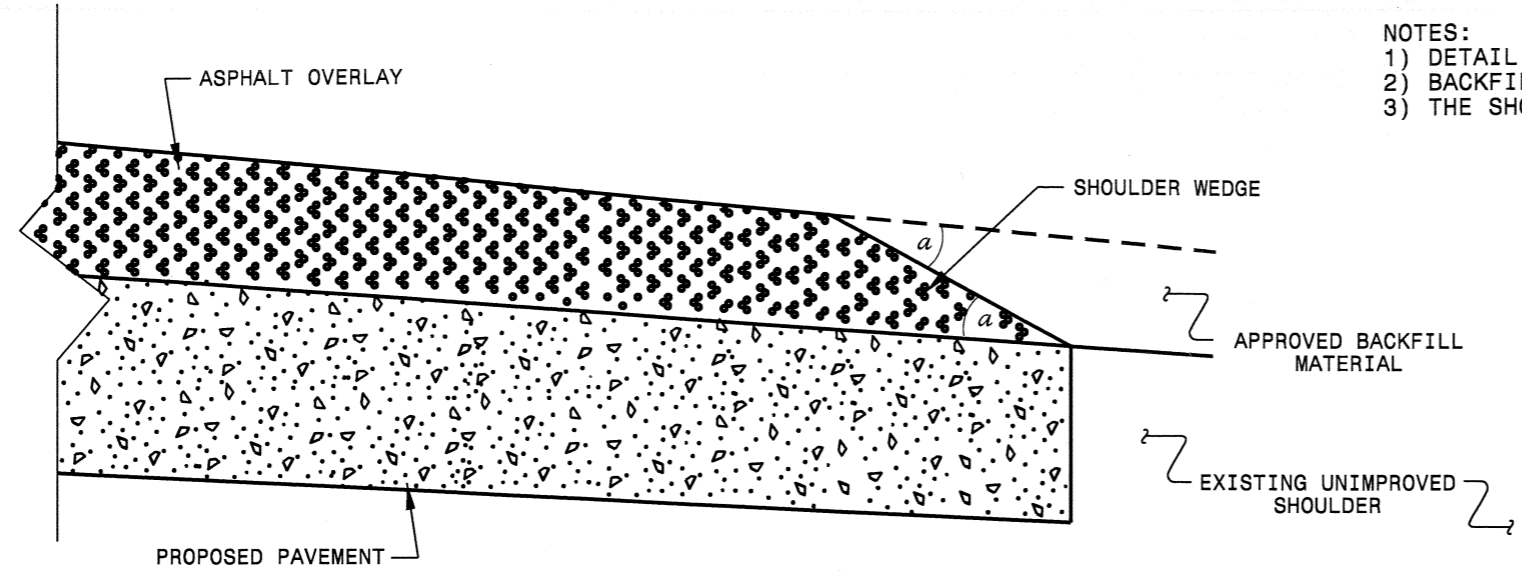

**SHOULDER WEDGE DETAIL**  
 (Resurfacing Projects w/ Widening or  
 with Existing Paved Shoulder having no dropoffs)

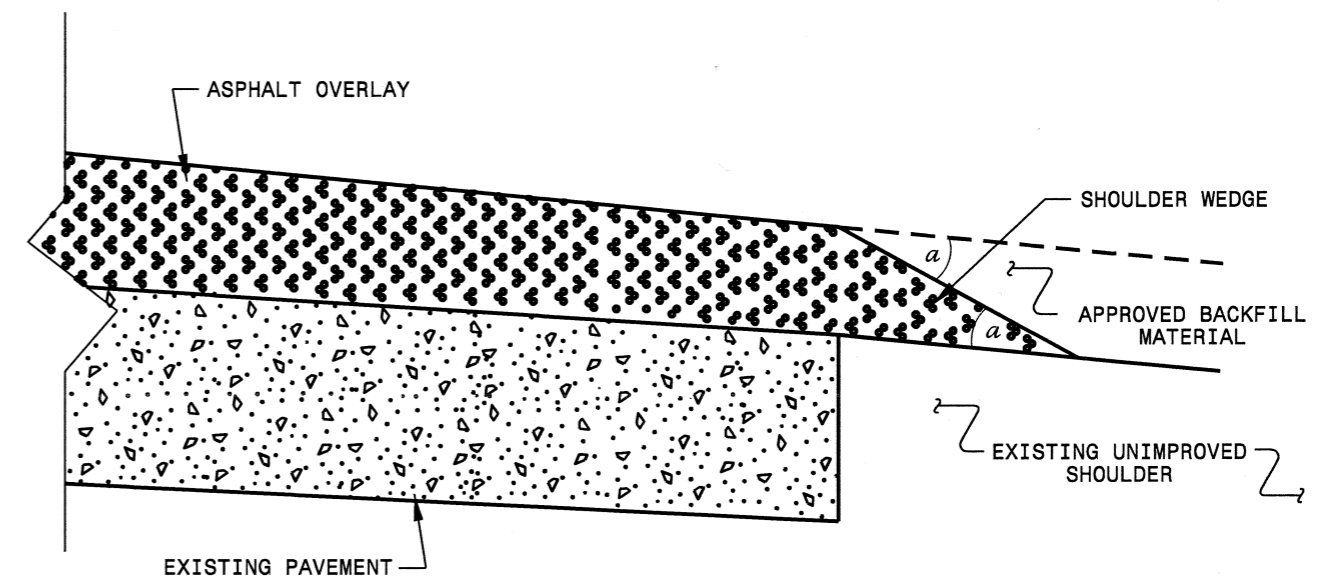

**SHOULDER WEDGE DETAIL**  
 (Resurfacing Projects w/ NO Widening)

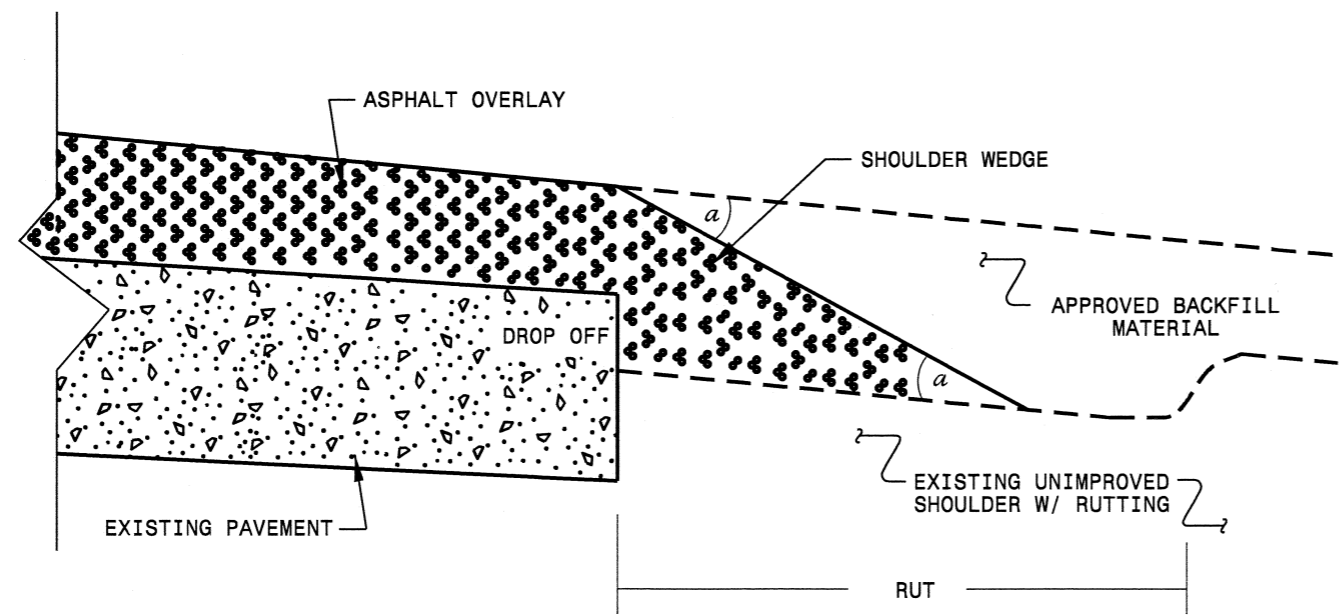

**SHOULDER WEDGE DETAIL**  
 (Resurfacing Adjacent to  
 Rutted Shoulder)

- SHOULDER WEDGE ANGLE = 30°

<b>CONTRACT STANDARDS AND DEVELOPMENT UNIT</b>	
Office 919-707-6950 FAX 919-250-4119	
<b>SHOULDER WEDGE DETAILS</b>	
ORIGINAL BY: T.SPELL	DATE: 7-19-11
MODIFIED BY:	DATE: 10/18/12
CHECKED BY:	DATE:
FILE SPEC.: s:\user\details\stand\shoulderwedgedetail.dgn	

\*\*\*\*\*  
 SYSTEMS CONSULTANTS  
 10000 WILSON ROAD  
 SUITE 100  
 WILSON, NC 27157  
 \*\*\*\*\*

# SIGNING FOR RESURFACING PROJECTS

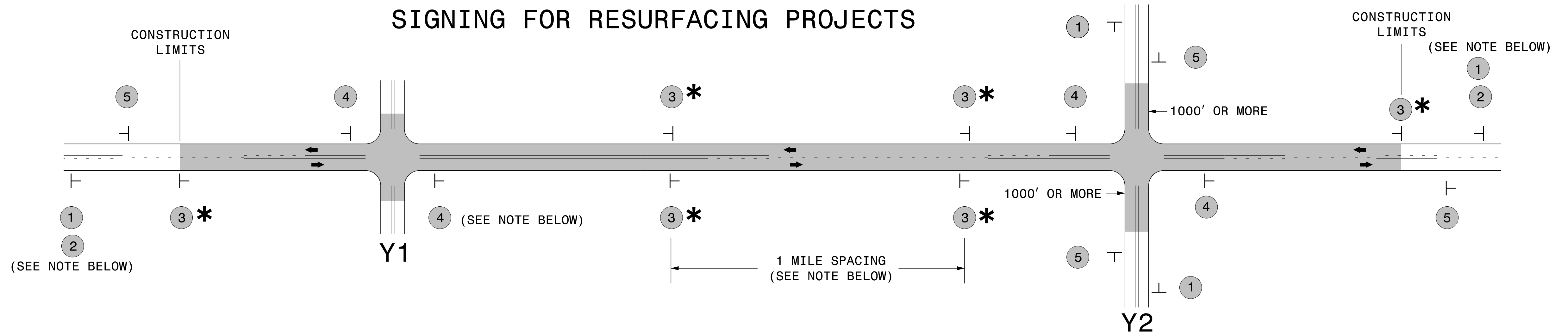

LEGEND	
┆	STATIONARY SIGN
←	DIRECTION OF TRAFFIC FLOW

## MAINLINE (-L-) SIGNING

## -Y- LINE SIGNING

SIGNING NOTES AND PLACEMENT PER DIRECTION	MAINLINE (-L-) SIGNING		-Y- LINE SIGNING	
	1	 <small>W20-1 48" X 48"</small>	<p>PLACE 1000' PRIOR TO BEGINNING OF CONSTRUCTION LIMITS. ONLY USED ON -Y- LINES IF RESURFACING LIMITS EXTEND 1000' ALONG -Y- LINE.</p>	<p>NO REQUIRED STATIONARY SIGNING FOR THE FOLLOWING -Y- LINE CONDITIONS:</p> <ol style="list-style-type: none"> <li>1) LESS THAN 1000' OF RESURFACING ALONG -Y- LINE</li> <li>2) SUBDIVISION ROADS</li> <li>3) DEAD END ROADS</li> </ol> <p>WHEN PAVING/CONSTRUCTION ACTIVITIES PROCEED ACROSS AN UNSIGNED -Y- LINE, ADVANCE WARNING PORTABLE SIGNS SHALL BE USED ALONG THE -Y- LINE AS SHOWN BELOW. REMOVE UPON COMPLETION OF WORK.</p> <div style="display: flex; justify-content: space-around;"> <div style="text-align: center;">   <small>W20-1 48" X 48"</small> </div> <div style="text-align: center;">   <small>W20-7 A 48" X 48"</small> </div> </div> <p>PLACED 500' IN ADVANCE OF FLAGGER. PLACED 250' IN ADVANCE OF FLAGGER.</p>
	2	 <small>W7-3aP 24" X 18"</small>	<p>#2 SIGN ONLY USED WHEN RESURFACING LIMITS ARE 2 OR MORE MILES IN LENGTH. ROUND UP TO NEXT WHOLE NUMBER. (NO FRACTIONAL OR DECIMAL NUMBERS)</p>	
	3 *	 <small>SP 13107 48" X 48"</small>	<p>PLACE INITIALLY AT THE CONSTRUCTION LIMITS AND SPACED 1 MILE APART THEREAFTER. IF NO -Y- LINES EXIST, PLACE 2ND SET 1/2 MILE FROM THE CONSTRUCTION LIMITS AND THEN SPACE 1 MILE THEREAFTER.</p>	
	4	 <small>SP 13106 48" X 48"</small>	<p>THESE ARE FOR -Y- LINES THAT ARE "THROUGH" ROADWAYS. DEAD END AND SUBDIVISION ROADS ARE NOT "THROUGH" ROADWAYS. INSTALL 500' +/- FROM EACH -Y- LINE APPROACH AS SHOWN ABOVE. FOR MULTIPLE -Y- LINES THAT ARE SEPARATED BY 0.25 MILES OR LESS, TREAT AS A SINGLE UNIT AND INSTALL WITHIN 500' OF EACH APPROACH. A MAXIMUM OF 2 SIGN SETS PER MILE. DO NOT INSTALL WHEN -Y- LINES ARE WITHIN 0.5 MILES FROM "END ROAD WORK" SIGN.</p>	
5	 <small>G20-2 A 48" X 24"</small>	<p>PLACE 500' FOLLOWING THE END OF CONSTRUCTION LIMITS.</p>		

### \* SIGNING FOR ASPHALT SURFACE TREATMENTS (ONLY)

SUBSTITUTE LOW/SOFT SHOULDER SIGNS BY ALTERNATING THE FOLLOWING TWO SIGNS: STARTING WITH "UNMARKED PAVEMENT AHEAD" (SP 06026) FOLLOWED BY "LOOSE GRAVEL" (W8-7).

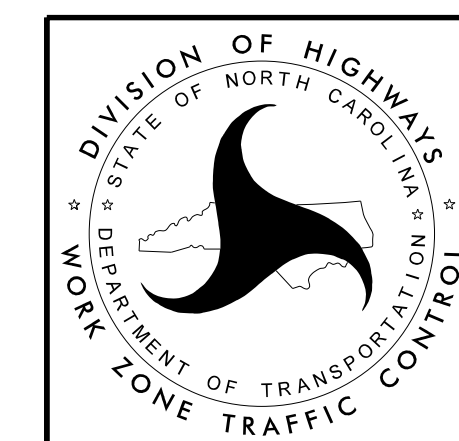

RESURFACING  
ADVANCE WARNING SIGNS  
FOR  
RURAL AND SUBURBAN  
2 LANE ROADWAYS